



13 Gurnard Road

, Portsmouth, PO6 3HN

Offers in excess of £270,000

We are delighted to bring you this well presented, extended 3 double bedroom semi detached home with private garden & driveway in easy reach of QA Hospital, access to the M27 & Cosham train station, as well as local shops, schools & amenities.

- Well Presented Throughout
- Three Double Bedrooms
- Private Garden
- Driveway for Two Cars
- Close to QA Hospital
- Good Rental Returns
- Good Commuter Links
- Local Shops & Amenities close by

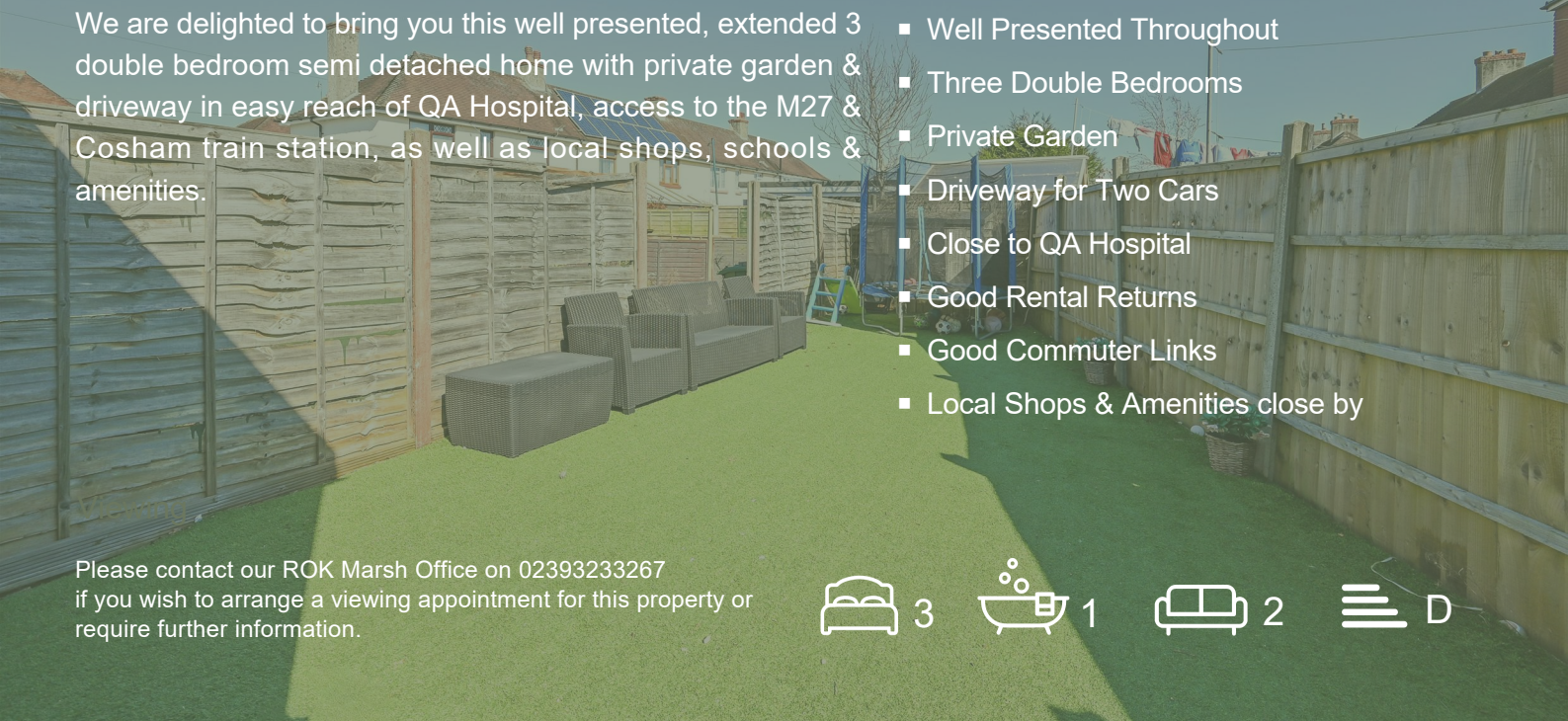

Please contact our ROK Marsh Office on 02393233267 if you wish to arrange a viewing appointment for this property or require further information.



3



1



2



D

Floor Plan

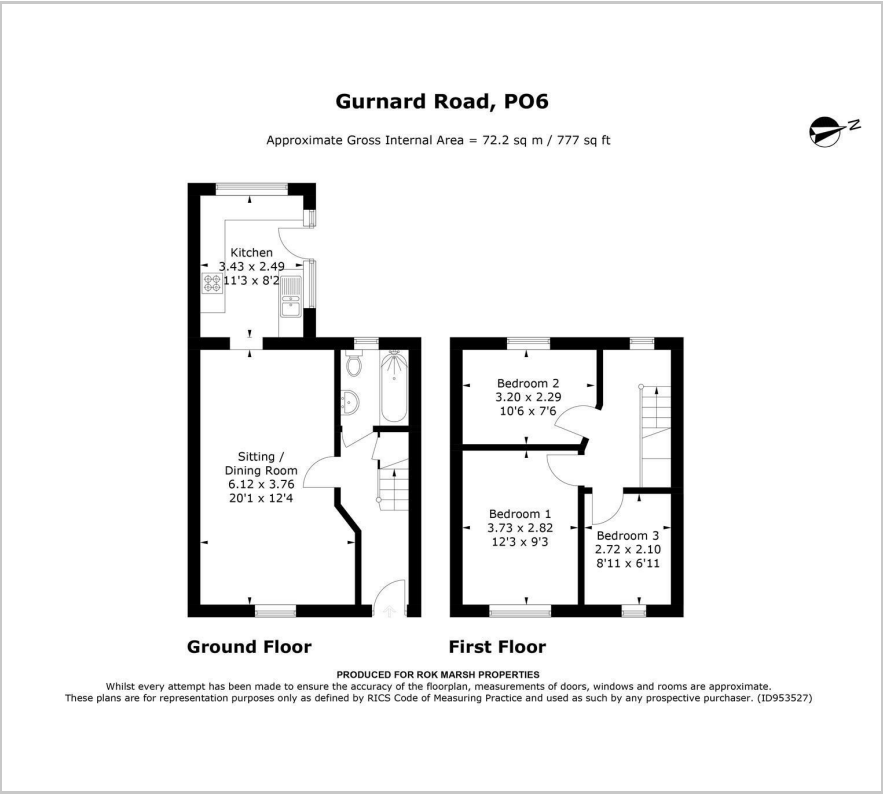

Area Map



Energy Efficiency Graph

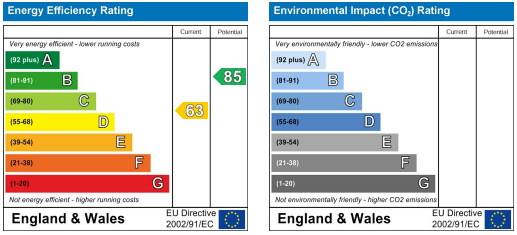

These particulars, whilst believed to be accurate are set out as a general outline only for guidance and do not constitute any part of an offer or contract. Intending purchasers should not rely on them as statements of representation of fact, but must satisfy themselves by inspection or otherwise as to their accuracy. No person in this firms employment has the authority to make or give any representation or warranty in respect of the property.